

E175 BB Tapping & Facing Tool

- en ▶ BB tapping and facing tool, English
- nl ▶ Trapas Engelse(BSA) draadtap en vlakrees gereedschap
- de ▶ Bearbeitungswerkzeug Tretlager Englisch und Fräswerkzeug
- fr ▶ Outils de surfacage et taraudage pour boîtier norme anglaise
- es ▶ Macho rosca inglesa para eje de pedalier

- ru ▶ Набор для торцевания и нарезки резьбы в каретке
- pt ▶ Jogo de ferramentas para fresar e facear movimento central de rosca
- it ▶ Kit per maschiatura serie movimento
- 正 ▶ 銑中軸螺紋及切端面工具組
 - 適用於英制螺紋(1.37"BC24T)
- 筒 ▶ 銑中軸螺紋及切端面工具套裝
 - 适用于英制螺紋(1.37"BC24T)

English Thread

- ▶ **Tapping 1.37"x24TPI**
 - E173L Tap, English (1.37" x 24TPI), for left side.
 - E173R Tap, English (1.37" x 24TPI), for right side.

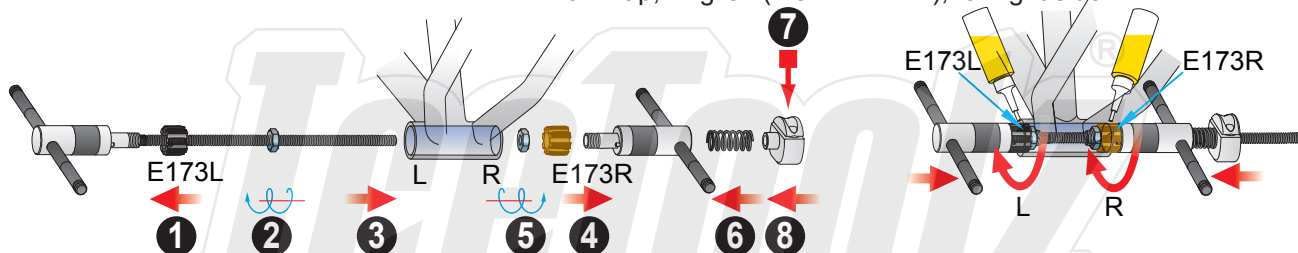

- ▶ **Facing**
 - E171F BB facer.
 - E171L BB screw, English (1.37" x 24TPI), for left side.
 - E171R BB screw, English (1.37" x 24TPI), for right side.

